



**RICOCHET**  
mesh technology



- Do not throw into a fire
- Do not short circuit
- Replace only with same or equivalent type(3V)
- Always observe local regulations when disposing of a battery
- Detector will transmit low battery warning when battery needs replacing
- Do not heat
- Do not charge
- Do not disassemble

2 year replacement warranty (excludes battery).

The *Premier Elite XT-W/QD-W* is designed to detect the movement of an intruder and activate an alarm control panel. As the *Premier Elite XT-W/QD-W* is not a complete alarm system, but only a part thereof, Texecom cannot accept responsibility or liability for any damages whatsoever based on a claim that the *Premier Elite XT-W/QD-W* failed to function correctly.

Due to our policy of continuous improvement Texecom reserves the right to change specification without prior notice. All specifications are measured at 20°C (68°F).



**Made In  
England**



Premier Elite and the wireless logo are trade marks of Texcom Ltd. © 2010  
The Premier Elite XT-W/QD-W is protected by European Registered Design. No: 3004997  
D20110109 INS466-3

- For wireless connectivity, detailed programming and system set-up instructions please refer to the compatible RICOCHET™ technology enabled *Premier* wireless expander instructions.

- Featuring RICOCHET™ wireless technology the *Premier Elite XT-W* and *Premier Elite QD-W* are designed for professional security installations.

<b>Alarm Systems:</b>	EN50131-2-2, EN50131-5-3, EN50131-1, PD6662, Grade 2 Class II
<b>EMC:</b>	EN50130-4:1995 A1: A2 ETSI EN301 489-03 V1.4.1
<b>R&amp;TTE:</b>	ETSI EN300-220 (V2.1.1)
<b>Environmental:</b>	EN50130-5
<b>Frequency Band:</b>	868.0 - 868.6 MHz / 433.05 - 434.79 MHz • Please refer to product label
<b>Receiver:</b>	Category 1, Class 2
<b>Receiver LBT (Listen Before Talk)</b>	Yes
<b>Transmitter Duty Cycle</b>	868MHz < 1%, 433MHz < 10%
<b>Low Voltage Signal</b>	2.85V
<b>Operating Voltage</b>	3V
<b>Maximum current</b>	32mA
<b>Quiescent current</b>	60uA

**Do not install close to large metal objects or mains wiring**

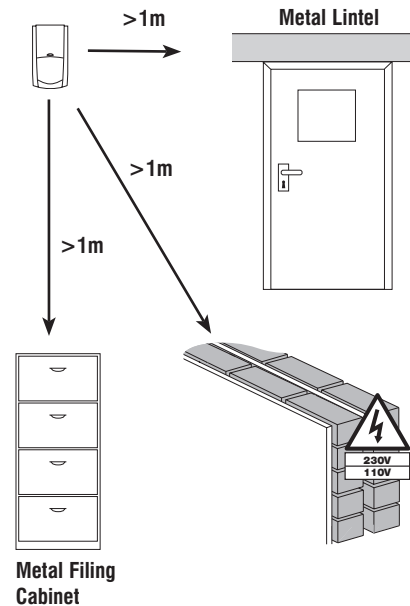

**Premier Elite QD-W Top View**

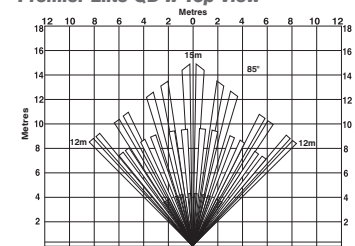

**Side View**

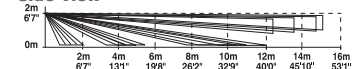

### Premier Elite XT-W Top View

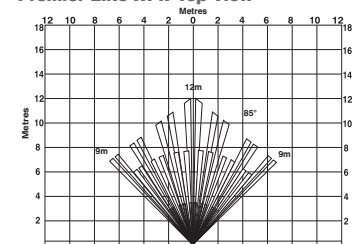

**Side View**

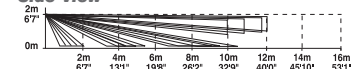

**ANGLING THE DETECTOR**

## ANGLING THE DETECTOR

## HOW TO REMOVE THE CHASSIS

Remove chassis before mounting the detector

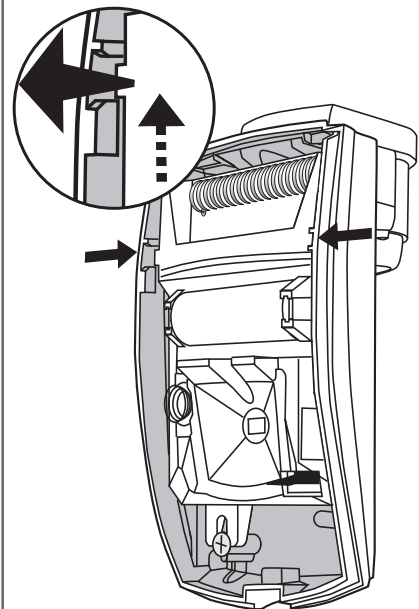

## DETECTOR KNOCKOUTS

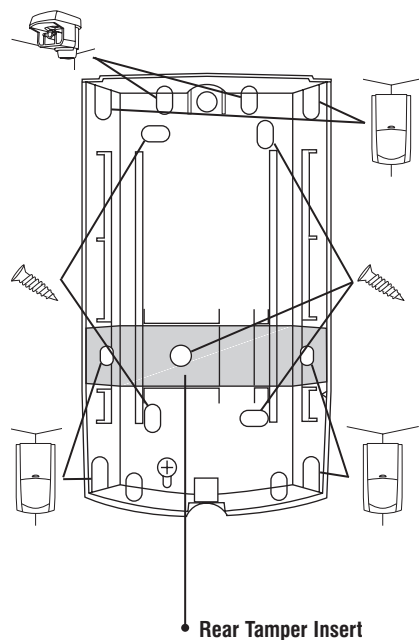

## CEILING MOUNT BRACKET\*

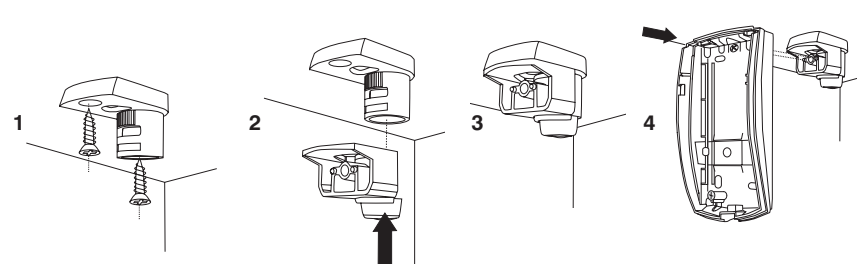

## WALL MOUNT BRACKET\*

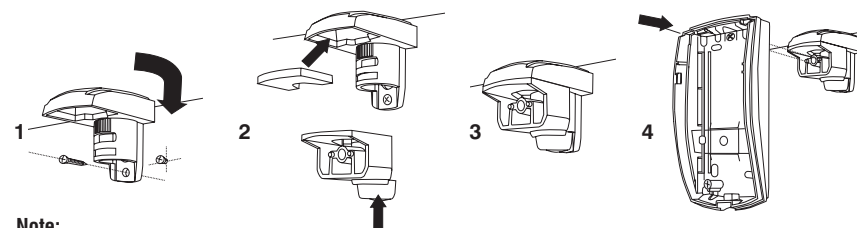

### Note:

For EN 50131 compliance both the detector and the rear tamper insert must be fixed to the wall, mounting brackets should not be used.

\*Available Separately

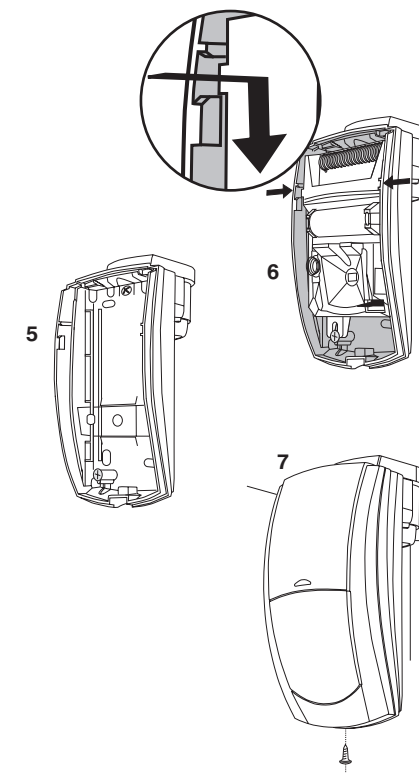

**Battery Tag**  
Remove on installation.

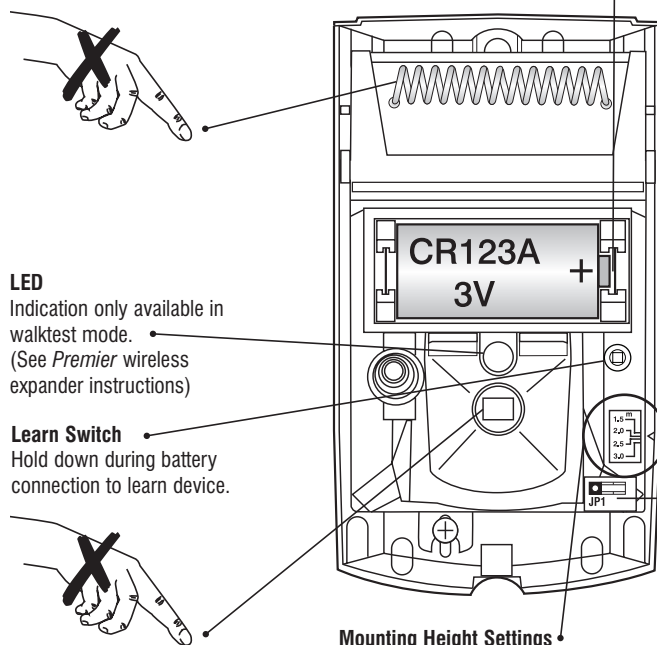

**LED**  
Indication only available in walktest mode.  
(See Premier wireless expander instructions)

**Learn Switch**  
Hold down during battery connection to learn device.

**Mounting Height Settings**

## XT PULSE COUNT

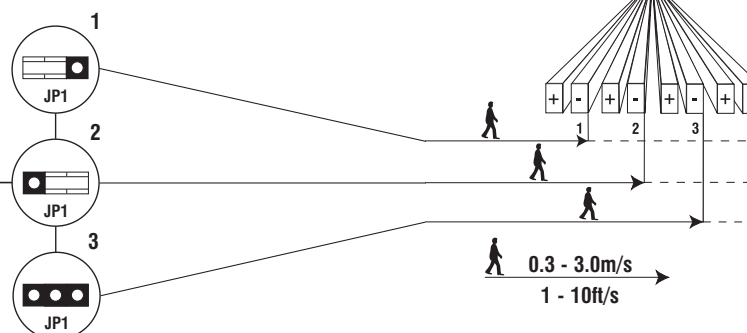

## QD PULSE COUNT

