



THANK YOU FOR VOTING TEXECOM

INSTALLATION MANUAL

Premier RKP8 Plus

Premier RKP16 Plus

Remote Keypads



Texecom
www.texe.com

1. INSTALLATION

The *Premier RKP8/16 Plus* remote keypads are suitable for use with the following Texecom control panels: *Premier 412* and *Premier 816* with **Version 2.1** or higher panel software. Up to 6 keypads may be connected to the system.

1.1 Mounting

Open the keypad by carefully inserting a small flat-blade screwdriver into each slot at the base of the unit. Gently push the screwdriver to ease the retaining clips upward, **DO NOT LEVER OR TWIST**. Excessive force is **NOT** required. The front flap and front cover can now be removed.

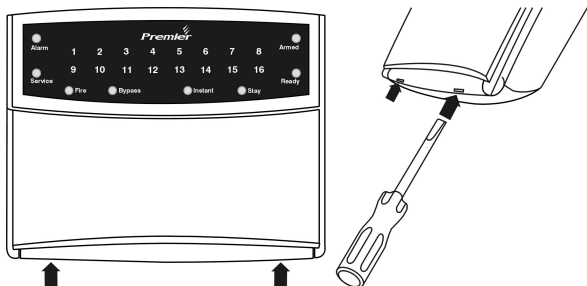

1.2 Selecting an Address

Each keypad **MUST** be given a different address using the DIP switch on the left hand side of the PCB as follows:

Address	DIP 1	DIP 2	DIP 3	DIP 4
1	Off or On	Off	Off	Off
2	Off	On	Off	Off
3	Off	Off	On	Off
4	Off	Off	Off	On
5	On	Off	Off	On
6	Off	On	Off	On



NEVER set two RKPs to the same address.

NOTE Keypads are factory set to Address 1 (all switches off).

1.3 Wiring

It is strongly recommended that the system is completely powered down (mains and battery) before wiring a keypad. Connect the keypad to the control panel using 4-core cable as follows:

Keypad	Control Panel
+	Data Bus +
-	Data Bus -
T	Data Bus T
R	Data Bus R

Up to six keypads may be connected in parallel ('star') or series ('daisy-chain') or any combination.



NOTE When using long cable runs or connecting keypads in series ('daisy-chain') ensure that the voltage at the keypad is no less than 10.0V.

When using 6-core or 8-core cable always use the spare cores to 'double-up' on 0V. This will allow longer cable runs particularly when connecting keypads in series ('daisy-chain'). As a rule 'trebling-up' on 0V will be more beneficial than 'doubling-up' on 12V and 0V.

The *Premier RKP8/16 Plus* has two fully programmable zone inputs (Z1 COM Z2). For information on wiring configuration options please refer to the *Premier 412/816 Installation Manual*.

1.4 Programming

When the system is powered up it automatically checks and configures all connected keypads.

In order to use the keypad zones, you must first enable the zones using Menu 43 Option 1 (refer to the *Premier 412/816 Installation Manual*). When a keypad has its zones enabled they are mapped onto the system as shown:

Keypad Address	RKP Z1	RKP Z2
1	Zone 9	Zone 10
2	Zone 11	Zone 12
3	Zone 13	Zone 14
4	Zone 15	Zone 16
5	Not Available	Not Available
6	Not Available	Not Available

1.5 Technical Specifications

Operating Voltage:	9 – 13.7VDC
Current Consumption:	Nominal: 35mA; When fully back lit: 85mA
Zone Indicators:	16 on the <i>RKP16 Plus</i> ; 8 on the <i>RKP8 Plus</i>
Status Indicators:	Alarm: Red; Service: Yellow; Fire: Red; Bypass/Omit: Red; Instant: Red; Stay/Part: Red; Ready: Green; Armed: Red
Data Bus:	4-wire up to 250m Star, Daisy-Chain or any combination
Operating Temperature:	-10°C to +45°C
Storage Temperature:	-20°C to +60°C
Maximum Humidity:	95% non-condensing
EMC Environment:	Residential/Commercial/Light Industrial or Industrial
Dimensions:	140mm x 115mm x 30mm
Packed Weight:	260g Approx.

1.6 Standards

Conforms to European Union (EU) Electro-Magnetic Compatibility (EMC) Directive 89/336/EEC (amended by 92/31/EEC and 93/68/EEC).

The CE mark indicates that this product complies with the European requirements for safety, health, environmental and customer protection.

1.7 Warranty

All Texecom products are designed for reliable, trouble-free operation. Quality is carefully monitored by extensive computerised testing. As a result the *Premier RKP8/16 Plus* is covered by a two year warranty against defects in material or workmanship (details on request).

As the *Premier RKP8/16 Plus* is not a complete alarm system but only a part thereof, Texecom cannot accept responsibility or liability for any damages whatsoever based on a claim that the *Premier RKP8/16 Plus* failed to function correctly. Due to our policy of continuous improvement Texecom reserve the right to change specification without prior notice.