

# RadioPlus PIR

Wireless 868MHz & 433MHz PIR's

## INSTALLATION INSTRUCTIONS



THANK YOU FOR VOTING TEXECOM

Ask your distributor today for the Texecom full colour Product Guide.

**Texecom**  
www.texe.com

## QUALITY ASSURANCE



Certificate Number: FM 35285

Made In England



## WARRANTY

1 year replacement warranty (excludes battery).

The *RadioPlus PIR* is designed to detect the movement of an intruder and activate an alarm control panel. As the *RadioPlus PIR* is not a complete alarm system, but only a part thereof, Texecom cannot accept responsibility or liability for any damages whatsoever based on a claim that the *RadioPlus PIR* failed to function correctly.

Due to our policy of continuous improvement Texecom reserves the right to change specification without prior notice. All specifications are measured at 20°C (68°F).

© 2005 Texecom Ltd. Document Ref: RPP/IR/EU/1.0

The *RadioPlus PIR* is protected by UK & International Registered Designs. Registered Design No's: 3004997, 3004260 & 3004261. RadioPlus is a Trademark of Texecom Ltd.

## 5 TEST MODES

- Pressing the test button for less than 1 second (<1s) initiates 'Walk Test Mode'. This enables the LED to allow checking of the coverage area. The detector does not transmit detections.
- Pressing the test button for more than 2 seconds (>2s) instructs 'RF Test Mode', where the detector repeatedly transmits alarm signals to allow checking of RF signal strength.

Both test modes last for 1 minute.

## 1 PHYSICAL

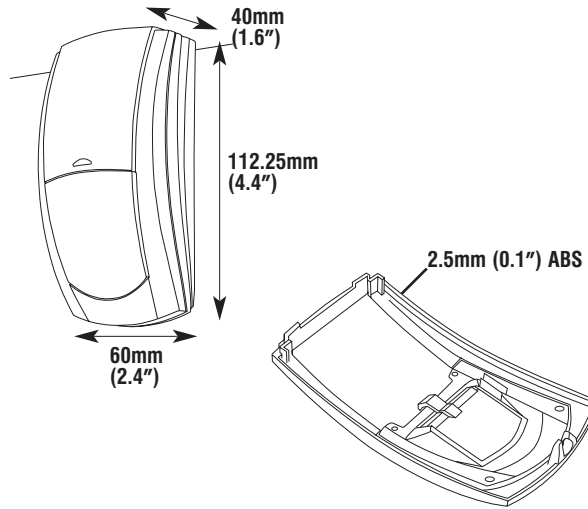

## 2 ENVIRONMENTAL

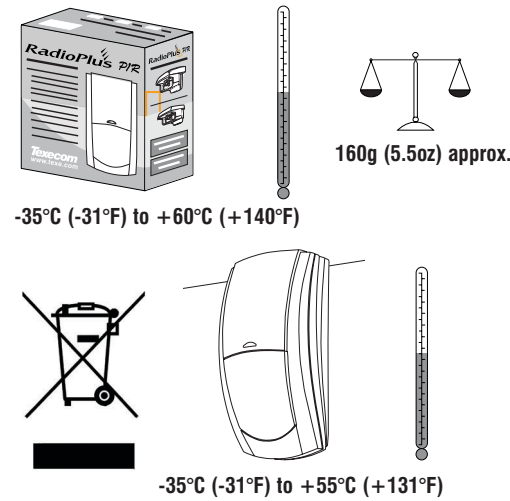

## 3 STANDARDS & APPROVALS

<b>Detector Standard:</b>	TS 50131-2-2 Grade 2 Environmental Class II.
<b>System Standard:</b>	Suggested use: within a BS EN 50131-1, PD6662 : 2004 Grade 2 system.
<b>Wireless Standard:</b>	Designed to comply with EN50131-5-3 : 2005.
<b>EMC:</b>	EN 300 489-1 : 2002. EN 300 489-3 : 2002. EN 50130-4 : 1995 + A1 : 1998 + A2 : 2003.
<b>RF Immunity:</b>	No false alarms from 80MHz to 1GHz at 10V/m. Complies with BS EN 61000-4-3 : 2002.
<b>Electrostatic Discharge:</b>	No false alarms up to 8kV. Complies with BS EN 61000-4-2 : 1995.
<b>Fast Transient Immunity:</b>	No false alarms up to ±4kV. Complies with BS EN 61000-4-4 : 1995.
<b>High Energy Transient Immunity:</b>	No false alarms up to ±2kV. Complies with BS EN 61000-4-5 : 1995.
<b>Conducted RF Susceptibility:</b>	No false alarms at 10Vrms. Complies with BS EN 61000-4-6 : 1996.
<b>Conducted Emissions:</b>	Complies with EN 55022 Class B.
<b>Radiated Emissions:</b>	EN 300 220-1 : 2000. EN 300 220-3 : 2000. 868MHz & 433MHz options.

## 4

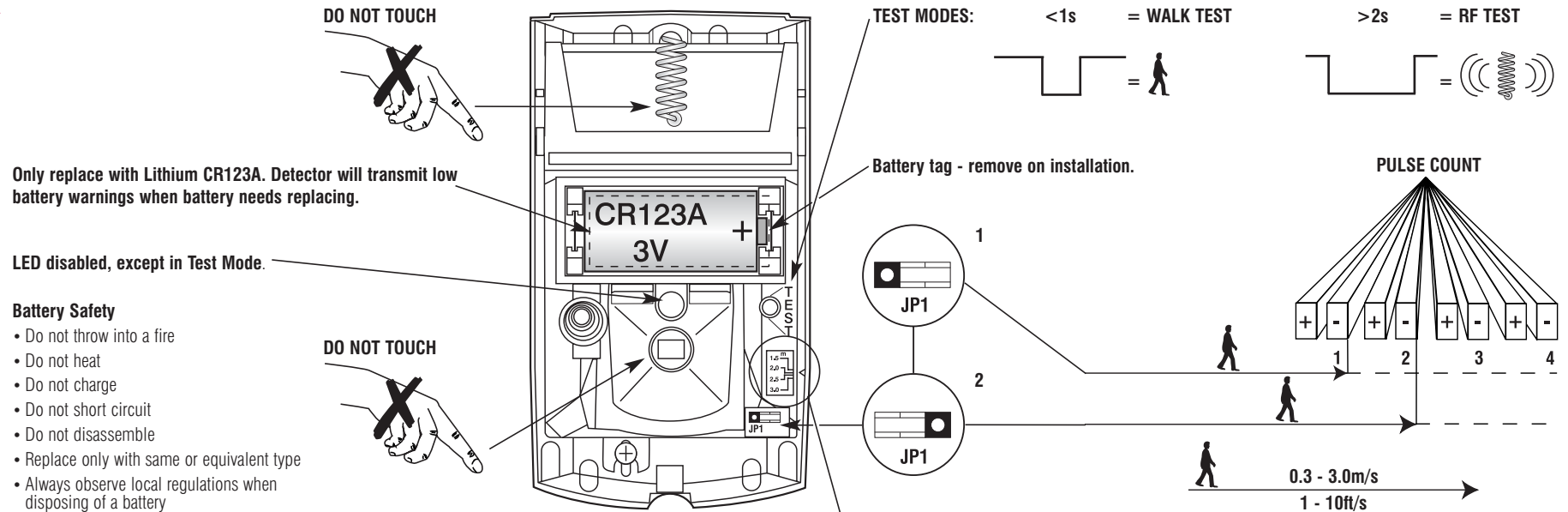

## 6 ANGLING THE DETECTOR

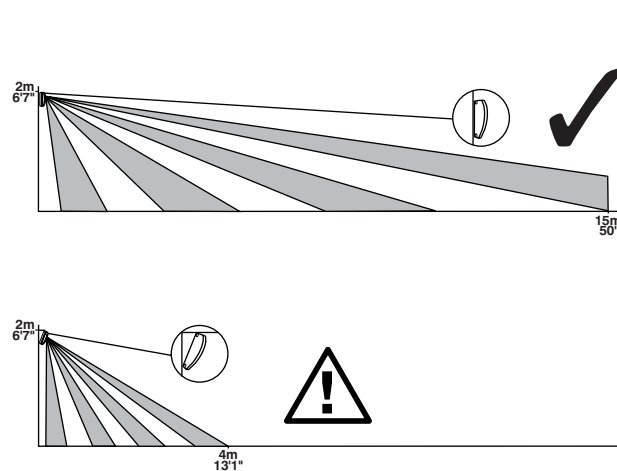

## 7 MOUNTING HEIGHT & SETTINGS

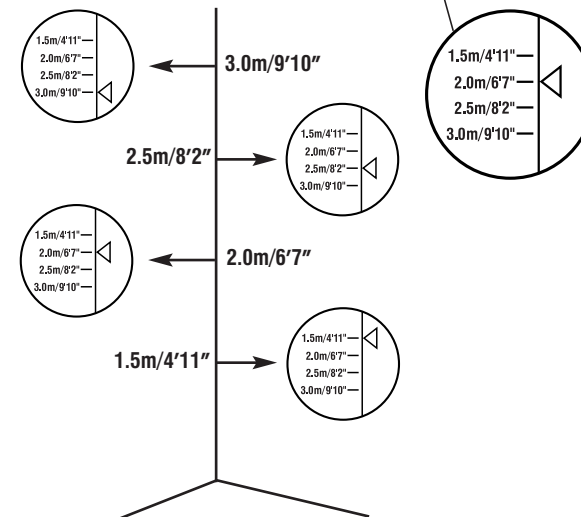

## 8 ALTERING COVERAGE AT 2m MOUNTING HEIGHT

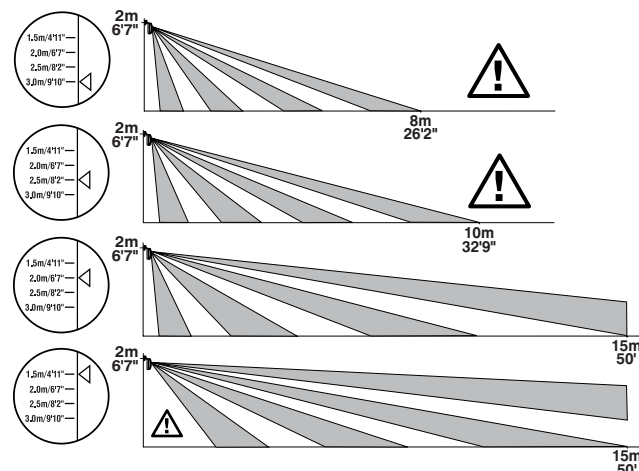

## 9 COVERAGE & PICK-UP

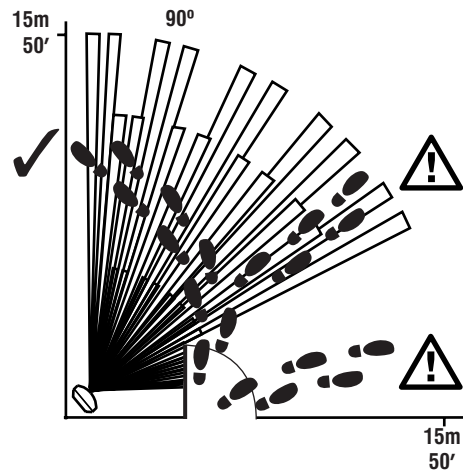

Do not install close to large metal objects or mains wiring

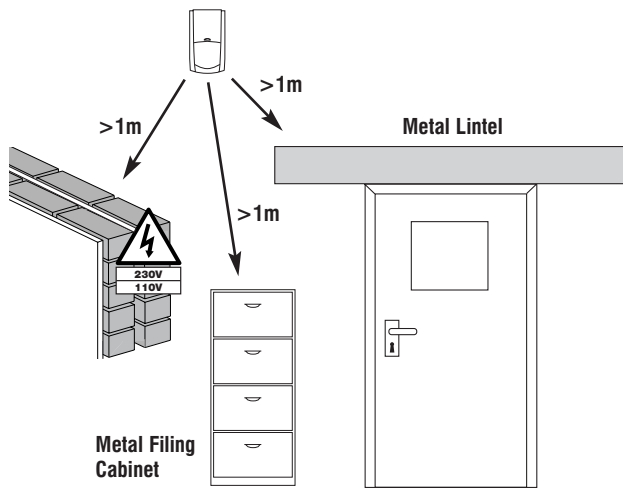

## 10 COVERAGE PATTERN

Volumetric

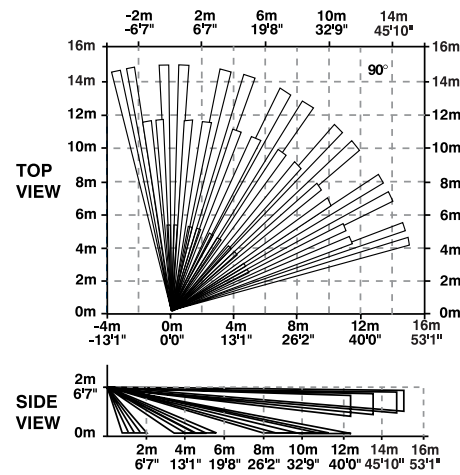

See Mounting Height Diagram (Section 7)

Avoid common false alarm sources

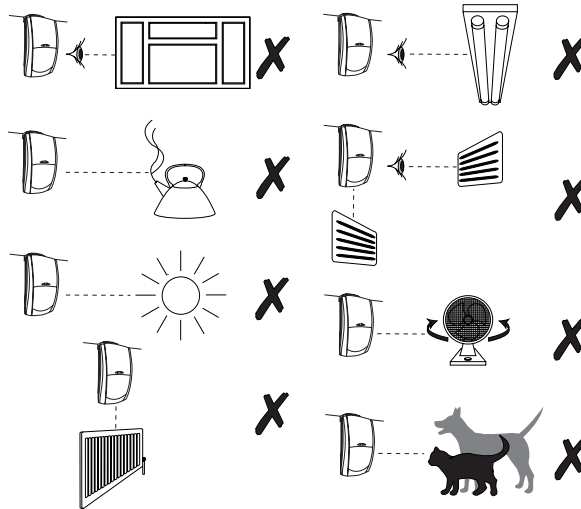

## 11 MOUNTING

For indoor use only

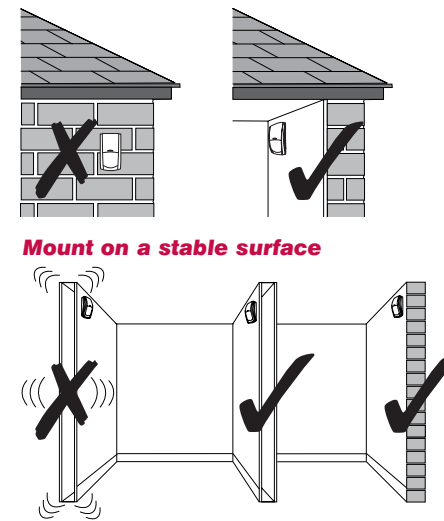

Mount on a stable surface

## 12 CHOOSING A LOCATION

Maximum range is 100m line of sight, walls and furniture will reduce this.

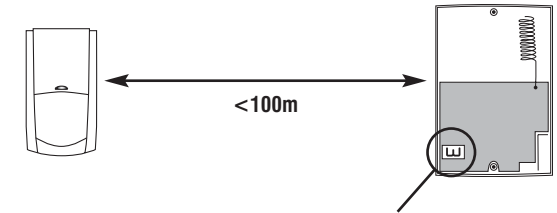

Before fixing PIR in place ensure received signal is greater than 3 (>3). See RadioPlus Intelligent Receiver installation instructions for more details.

## 13 HOW TO REMOVE THE CHASSIS

Remove chassis before mounting the detector

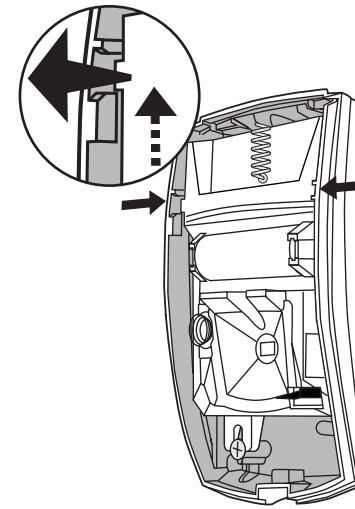

## 14 DETECTOR KNOCKOUTS

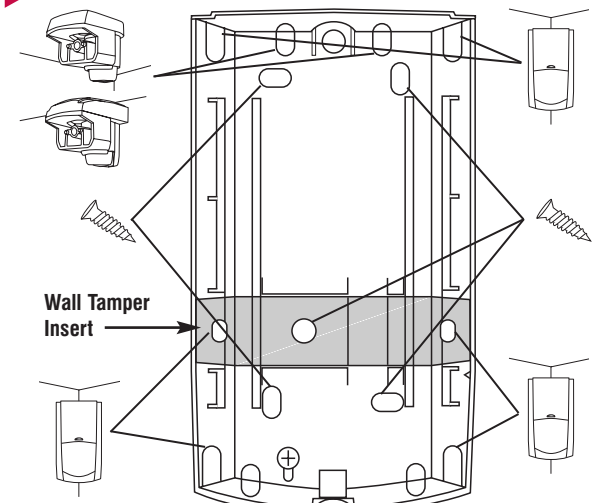

For rear/wall tamper - fix both the detector AND the wall tamper insert to the wall.

## 15 CEILING MOUNT BRACKET

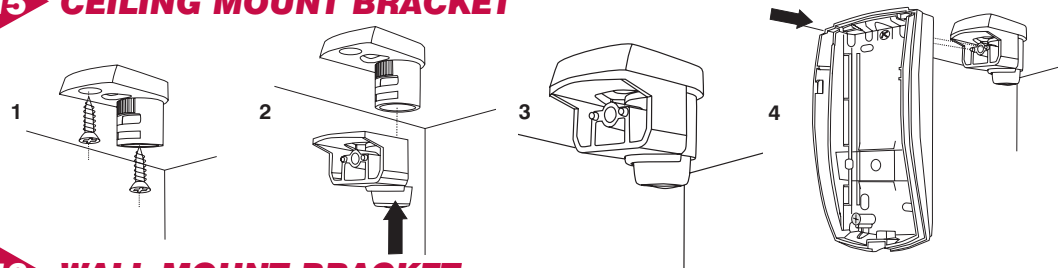

## 16 WALL MOUNT BRACKET

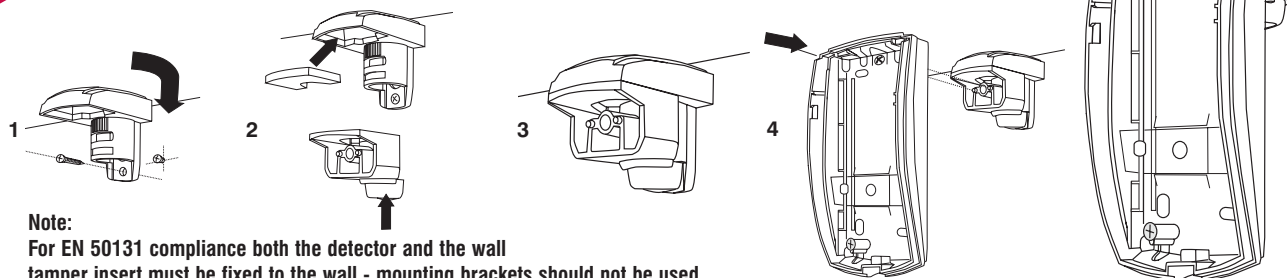

Note:  
For EN 50131 compliance both the detector and the wall tamper insert must be fixed to the wall - mounting brackets should not be used.

## 17 WIRELESS OPERATION

- Each detector has its own unique factory pre-set identification code, selected from over 16 million combinations.
- The LED is disabled to increase battery life (except in test modes).
- The detectors send approximately 12 'supervision' (monitoring) signals every 30 minutes.
- After a valid alarm transmission the detector will not transmit an alarm again until there has been no movement for 2 mins. This increases battery life when the system is unset and there are people in the building.
- The detector will transmit a battery low warning when there is just over one month's capacity remaining. The battery should be replaced at this time.